

INSTRUCTIONS

Duracell 750 Lumen with Zoom Focus Flashlight

SET UP

1. To open: Unscrew cap in counter-clockwise direction
2. Insert batteries with correct polarity as shown
3. To close: Screw cap in clockwise direction
4. Press rubber push-button to light

NOTE: Do not mix old and new batteries.
Do not use batteries over 1.5V in voltage.

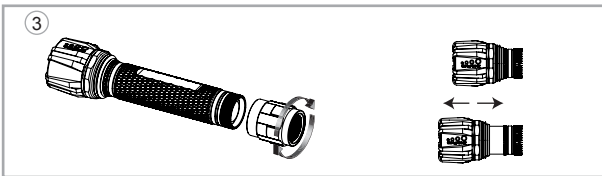
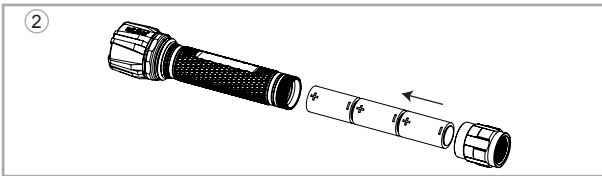
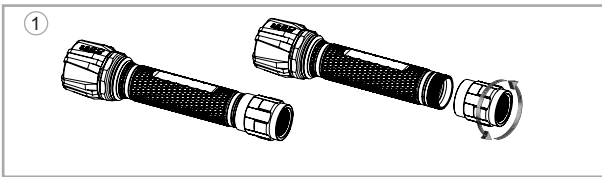

RUBBER CAP SWITCH

Press the switch at rubber end cap to operate

- a) Press one time for high level light
- b) Press two times for low level light

ZOOM FOCUS

Slide head of flashlight to select wide or narrow light beam.

Duracell 360 Lumen with Zoom Focus Flashlight

SET UP

1. To open: Unscrew cap in counter-clockwise direction.
2. Insert batteries into the battery holder. Insert batteries with correct polarity as shown on the battery holder.
3. To close: Screw cap in clockwise direction.
4. Press rubber push-button to light.

NOTE: Do not mix old and new batteries.
Do not use batteries over 1.5V in voltage.

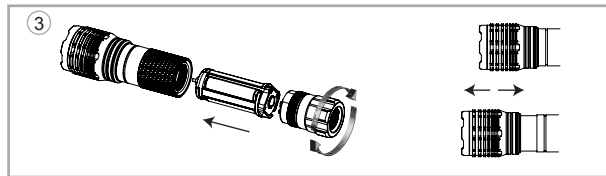
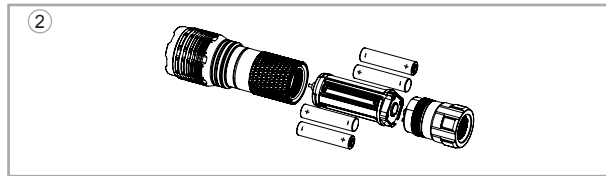
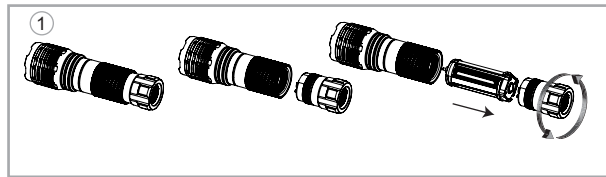

RUBBER CAP SWITCH

Press the switch at rubber end cap to operate

- a) Press one time for high level light
- b) Press two times for low level light

ZOOM FOCUS

Slide head of flashlight to select wide or narrow light beam.

CAUTION

CAUTION: Keep batteries from children. Do not swallow. If swallowed, consult a physician or call your local poison control at once for information on treatment. Ingestion may lead to serious injury or death. Batteries may explode or leak, and cause burn injury, if recharged, disposed of in fire, mixed with a different battery type, inserted backwards or disassembled. Replace all used batteries at the same time. Do not mix old and new batteries. Do not carry batteries loose in your pocket or purse. Do not remove the battery label. Do not shine LED light directly in the eyes.

FCC STATEMENT OF COMPLIANCE

NOTE

WARNING: Changes or modifications not approved by the party responsible for compliance could void user's authority to operate the equipment. This equipment has been tested and found to comply with the limits for a Class B digital device, pursuant to Part 15 of the FCC Rules. These limits are designed to provide reasonable protection against harmful interference in a residential installation. This equipment generates, uses and can radiate radio frequency energy and, if not installed and used in accordance with the instructions, may cause harmful interference to radio communications. However, there is no guarantee that interference will not occur in a particular installation. If this equipment does cause harmful interference to radio or television reception, which can be determined by turning the equipment off and on, the user is encouraged to try to correct the interference by one or more of the following measures:

- Reorient or relocate the receiving antenna.
- Increase the separation between the equipment and receiver.
- Connect the equipment into an outlet on a circuit different from that to which the receiver is connected.
- Consult the dealer or an experienced radio/TV technician for help.

Note: This device complies with Part 15 of the FCC Rules. Operation is subject to the following two conditions: (1) This device may not cause harmful interference, and (2) This device must accept any interference received, including interference that may cause undesired operation.

CAN ICES-005(B)/NMB-005(B). This Class B digital apparatus complies with Canadian ICES-005.

CAUTION

Always purchase the correct size and grade of battery most suitable for the intended use. Always replace the whole set of batteries at one time, taking care not to mix old and new ones, or batteries of different types. Clean the battery contacts and also those of the device prior to battery installation. Ensure the batteries are installed correctly with regard to polarity (+ and -). Remove used batteries promptly. Remove batteries from appliances that will not be used for long periods of time (months or longer). Keep contacts clean, both on the battery and in the appliance.



Please dispose of batteries according to local regulations for the battery chemistry.

Working Temperature: -10 °C to 40 °C / 14° F to 104° F

Compatible with alkaline batteries and rechargeable batteries.
DO NOT mix and use alkaline batteries with rechargeable batteries together.
For the best performance, use Duracell alkaline batteries.

©2018 DURACELL, Bethel, CT 06801. Duracell is a registered trademark of Duracell U.S. Operations, Inc., used under license. All rights reserved.

Customer Service for North America

1-888-910-2280

Hours: Monday-Friday, 8AM to 5PM Pacific Time